

# Cross Creek

## Medical Office Park



Key ► ENTRANCE ● P PARKING

- 1. \*Greenville Ear, Nose Throat and Allergy Associates
- 2. ATI Physical Therapy
- 6. Vacant (TBD)
- 9. Cross Creek Surgery Center
- 11. Prisma Health Orthopedics
- 15. Greenville Family Medicine (June 2021)
- 20. Center for Pediatric Medicine
- 28. \*Dermatology Associates
- 35. Greenville Midwifery Care
- 48. Pediatric Surgery and Pediatric Neurosurgery
- 50. Cross Creek Internal Medicine
- 57. Center for Pediatric Medicine–Infusion, Ferlauto Center for Complex Pediatric Care
- 105. Department of Orthopedics
- 109. Southeastern Neurosurgical & Spine Institute
- 111. Pain Medicine–Downtown  
Upstate Pharmacy  
ATI Physical Therapy
- 113. \*Southern Eye Associates

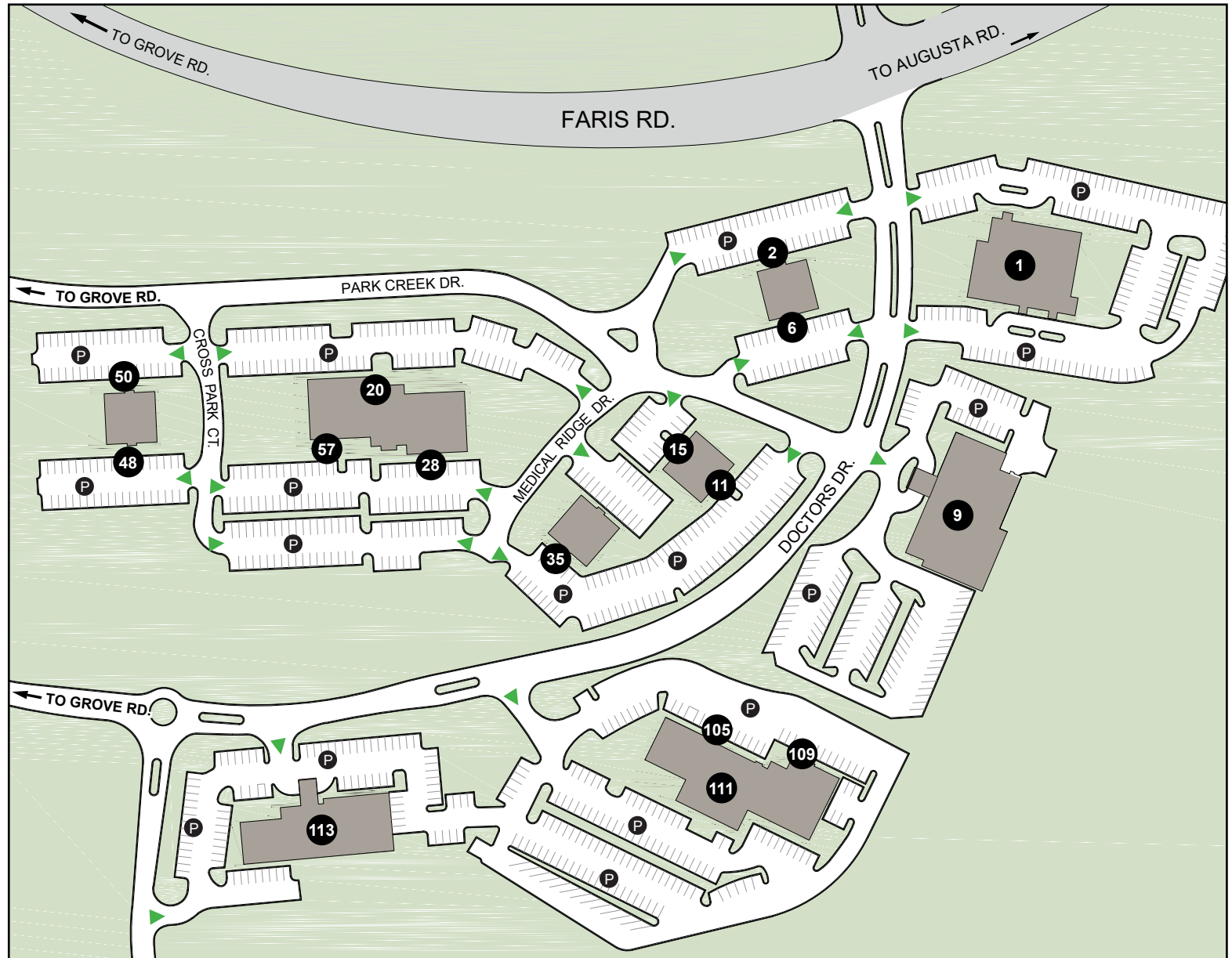

\* These locations are not affiliated with Prisma Health.